

Contents

(English Version)

I. Disclaimers, Exclusions and Limitations of Liability	pg. 04
II. About this book	pg. 05
III. About your Presidium Electronic Gem Gauge	pg. 06
IV. IMPORTANT NOTICE	pg. 08
1. GETTING STARTED with your Presidium Electronic Gem Gauge	pg. 10
2. PERFORMING A TEST with your Presidium Electronic Gem Gauge	pg. 11
3. TAKING CARE of your Presidium Electronic Gem Gauge	pg. 14

I. Disclaimer, Exclusion and Limitations of Liability

PLEASE READ AND NOTE PRESIDIUM WARRANTY TERMS AND CONDITIONS as stated in the warranty card. Presidium warranty for its testers are subject to proper use by its users in accordance with all the terms and conditions as stated in the relevant user handbook and shall cover only manufacturing defects.

Due to continuous product improvement, Presidium reserves the right to revise all documents including the right to make changes to the handbook without notice and without obligation to notify any person of such revisions or changes. Users are advised to check Presidium's website <http://www.presidium.com.sg/> from time to time.

Presidium shall not be responsible for any damage or loss resulting from the use of this gauge or handbook, and under no circumstances shall Presidium, its manufacturer or any of its subsidiaries, licensors, distributors, resellers, servants and/or agents be liable for any direct or indirect damages, resulting from the use of this gauge.

TO THE MAXIMUM EXTENT PERMITTED BY APPLICABLE LAW, under no circumstances shall Presidium, its manufacturer or any of its subsidiaries, licensors, distributors, resellers, servants and/or agents be responsible for any special, incidental, consequential or indirect damages howsoever caused.

The gauge or Presidium Electronic Gem Gauge (PEGG) referred to in this handbook is provided and/or sold on an "as is" basis. Except as required by applicable law, no warranties of any kind, either expressed or implied, including, but not limited to, the implied warranties of merchantability and fitness for a particular purpose.

II. About this book

Thank you for purchasing the Presidium Electronic Gem Gauge (“PEGG” or “gauge”).

This handbook is designed to help you set up your gauge and describes all you need to know about how to use your gauge accurately and take care of it in line with its requirements. Please read these instructions carefully and keep them handy for future reference.

This book also contains the terms and conditions in relation to the use of the gauge including the **Disclaimer, Exclusion and Limitation of Liability clauses stated above in Section I.**

III. About your Presidium Electronic Gem Gauge

The Presidium Electronic Gem Gauge utilizes capacitance measurement in which the capacitance IC output the change in capacitance of two sliding plates into binary values and finally being converted by equations in microprocessor into dimension (in millimeters) and weight (in carat).

The Presidium Electronic Gem Gauge features the following:

- Measures from 0.0 to 25.0mm
- Accuracy: 0.01mm / Tolerance: 0.02mm
- Direct digital millimeter/carat readout
- Touch button zeroing that allows the convenience of resetting to zero at any measurement point
- Smooth slider mechanism
- Low power consumption
- Portable and lightweight
- Auto-magnetic power off when placed in carrying case

Product specifications:

- Measurement range: 0.00mm-25.00mm
- Accuracy: 0.01mm / Tolerance: 0.02mm
- Recommended battery: CR2032
- Battery lifespan: generally about 16 hours of continuous usage

Included in your package:

- Presidium Electronic Gemstone Gauge
- High setting jewelry attachment
- Presidium Gemstone Weight Estimation Table
- Quick Guide
- QR Code Card
- Plastic carrying case

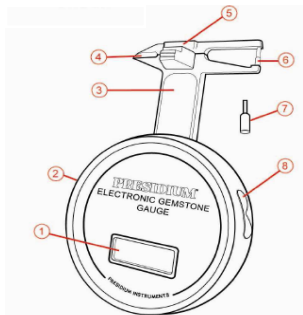

1	Display Window
2	Battery Compartment
3	Slider
4	Wedge-shaped Points
5	Fixed Rod
6	Protruding Probe
7	Jewelry Attachment
8	Zero Reset / ct/mm conversion Button

IV. IMPORTANT NOTICE

- Keep the gauge dry. Precipitation and all types of liquids or moisture can contain minerals that will corrode electronic circuits. If your gauge does get wet, remove the battery, and allow the gauge to dry completely before replacing it.
- Do not use, store or expose the gauge in dusty and dirty areas. Its moving parts and electronic components can be damaged.
- Do not use, store or expose the gauge in hot areas. High temperatures can damage or shorten the life of the gauge, damage batteries, and warp or melt certain plastics.
- Do not use, store or expose the gauge in cold areas. When the gauge returns to its normal temperature, moisture can form inside the gauge and damage electronic circuit boards.
- Do not attempt to open the gauge other than as instructed in this handbook.
- Do not drop, knock, or shake the gauge. Rough handling might break internal circuit boards and fine mechanics.
- Do not use harsh chemicals, cleaning solvents, or strong detergents to clean the gauge.

- Do not paint the gauge. Paint can clog the moving parts and prevent proper operation.

If your gauge is not working properly, kindly contact Presidium Customer Service at service@presidium.com.sg or:

Presidium Instruments Pte Ltd
Unit 7, 207 Henderson Road
Singapore 159550
Attn: Customer Service Executive

1. GETTING STARTED with your Presidium Electronic Gem Gauge

Inserting the battery into your Presidium Electronic Gem Gauge

1. Pull the battery slider sideways outward using either fingernails or a screwdriver.
2. Place a CR 2032 3V battery with the (+) sign facing upward in the battery compartment and close by pushing the battery slider sideways inward (**Fig. 1.1**).
3. The use of alkaline batteries is preferred, as it should generally give approximately two and a half hours of continuous operation, while the use of ordinary batteries will give a shorter working life.

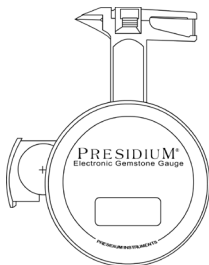

Fig. 1.1

Battery information

Do not leave worn out batteries in the battery compartment as the batteries may corrode, leak or damage the gauge. Batteries should be removed when the instrument is expected to be stored for an extended period of time.

2. PERFORMING A TEST with your Presidium Electronic Gem Gauge

- The Presidium Electronic Gem Gauge should be held in the palm of either hand. Control the Slider with the thumb (**Fig 2.1**).

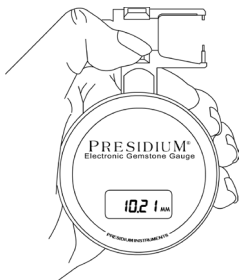

Fig. 2.1

- When measuring loose stones, pull the Slider (**Fig. 2.2**) and place the stone on the Slider platform. The base of the stone should be parallel to the platform to prevent it from moving.

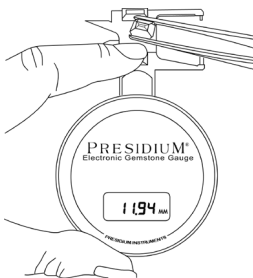

Fig. 2.2

- Slowly close the Slider. The reading will be displayed on the window immediately.
- Press MM/Ct (**Fig. 2.3**) to convert between dimension in millimeter or weight in carat.



Fig. 2.3

When measuring mounted stones, insert the jewelry attachment to the gauge (**Fig. 2.4**) and place the stone between the jewelry attachment and Slider anvil.



Fig. 2.4

- Slowly close the Slider (**Fig. 2.5**), the reading will be shown directly on the display window. Press MM/Ct (**Fig. 2.3**) to convert between dimension in millimeter or weight in carat.



Fig. 2.5

Functions of your Presidium Electronic Gem Gauge

Use the Wedge Shape Points when measuring:

- Stones mounted in rubbed over settings
- Interiors of empty settings
- Ring size

Use the Projecting Probe when measuring:

- Depth of mounted stones
- Width and length of large, loose stones, especially fancy cuts

Use the Jewelry Attachment when measuring:

- Depth of stones in high settings
- Depths of stones in settings with small holes

Please reset to zero after attaching this accessory (Fig. 2.6).

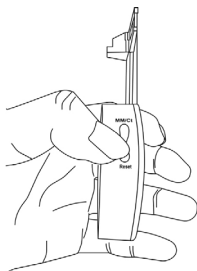

Fig. 2.6

3. TAKING CARE of your Presidium Electronic Gem Gauge

Do not leave worn out batteries in the battery compartment as the batteries may corrode, leak or damage the gauge. Batteries should be removed when the gauge is expected to be stored for an extended period of time.

Your gauge is a product of extensive design and craftsmanship and should be treated with care.

Thank you for taking time to go through the user handbook which will enable you to understand your recent purchase better.

Presidium also recommends that you register your warranty by sending the warranty registration card to us or registering online at <http://www.presidium.com.sg/>